

8" - 200W Professional Woofer

8 E2 1,5 CS 8 Ω
Code Z005090

GENERAL CHARACTERISTICS		
Nominal Overall Diameter	209	mm
Nominal Voice Coil Diameter	38	mm
Magnet Weight	640	g
Flux Density.....	1.16	T
Weight.....	2.00	Kg

ELECTRICAL CHARACTERISTICS	
Nominal Impedance.....	8 Ω
Musical Power	200 W
Rated Power*	100 W
Sensitivity @ 1 W, 1 m	93.3 dB

THIELE-SMALL PARAMETERS		
Voice Coil DC Resistance	R_E	6.60 Ω
Resonance Frequency	f_s	62.4 Hz
Mechanical Q Factor.....	Q_{MS}	2.27
Electrical Q Factor.....	Q_{ES}	0.53
Total Q Factor	Q_{TS}	0.43
Mechanical Moving Mass	M_{MS}	17.5 g
Mechanical Compliance	C_{MS}	370 μm/N
Force Factor	$B \times l$	9.27 Wb/m
Equivalent Acoustic Volume.....	V_{AS}	23.9 lt.
Maximum Linear Displacement	X_{MAX}	+/-2.0 mm
Reference Efficiency	η_0	1.06 %
Diaphragm Area	S_D	213.8 cm ²
Losses Electrical Resistance.....	R_{ES}	28.4 Ω
Voice Coil Inductance @ 1kHz	L_E	0.59 mH

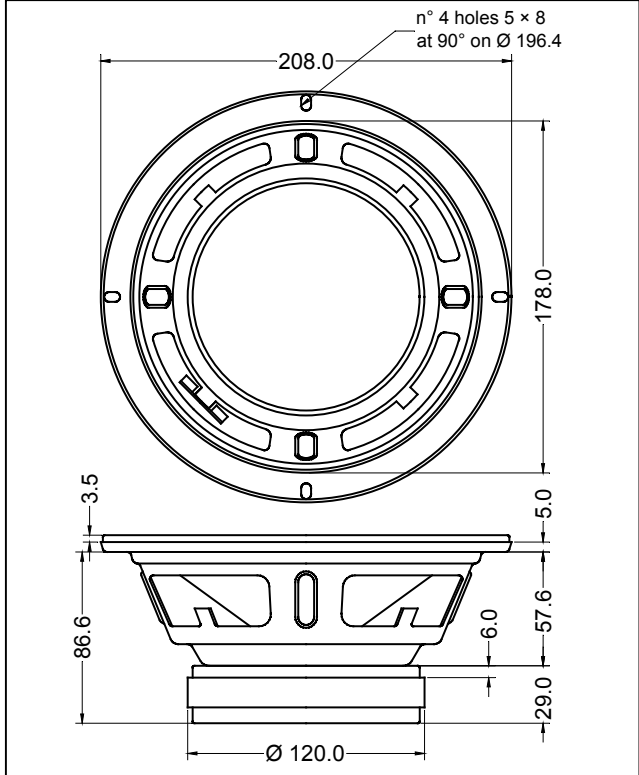

CONSTRUCTIVE CHARACTERISTICS	
Magnet.....	Ferrite
Voice Coil Winding.....	Copper
Voice Coil Former.....	Kapton
Cone	Paper
Surround.....	Treated Cloth
Dust Dome	Solid Paper
Basket	Pressed Sheet Steel

*rated power measured with 2 hours test with pink noise signal, 6 dB crest factor, loudspeaker mounted on enclosure
Thiele-Small parameters measured with LASER system

Frequency Response on IEC Baffle (DIN 45575) @ 1 W, 1 m - Free Air Impedance

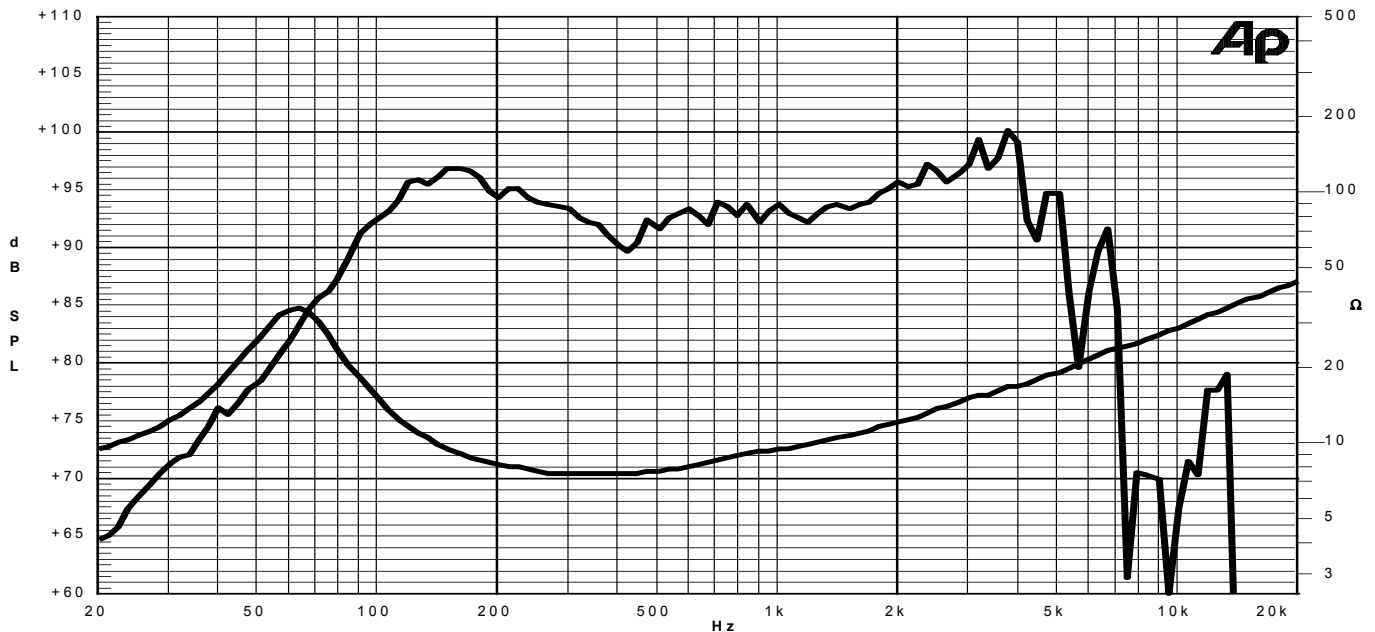

Due to continuing product improvement, the features and the design are subject to change without notice.

17/02/11